

**EXO-R710**

**SCORPION**  
**EXO**

**TECHMANUAL**

# EXO-R710 Performance Features

## 1 EverClear® No Fog FaceShield

**EVERCLEAR® NO-FOG FACESHIELD**  
Optically-clear shield with state-of-the-art fog free technology. Anti-Scratch hardened coating.

## 2 KwikWick II™ Liner Fabric

**KWIKWICK II™ LINER**  
KwikWick II® anti-microbial fabric keeps you cool and dry in warm weather, warm in cool weather. Liner is easily removable and washable. (See page 4-5 for details)

## 3 KwikFit™

**KWIKFIT**  
KwikFit™ cheekpads allow easy on and off of the most common styles of eye glasses

## 4 Ellip-Tec™ Ratchet System

**ELLIP-TEC™**  
Easy, Secure, tool-less faceshield changes in seconds. Pulls the shield back against the eyeport gasket during closing to ensure a proper seal. (See page 8 for details)

## 5 Aero-Tuned Ventilation

Four intake ports across the front of helmet forces cool air in while three exhaust vents maximize movement of hot air out.

## 6 Face Shield Lock / Vent System

Shield securely locks in place. Or turn down for a light air flow when riding at low speeds. (See page 3 for details)

## 7 Advanced Dual-Density EPS:

Advanced multi-layer EPS provides efficient energy displacement in key areas. EPS liner throughout entire chin bar area.

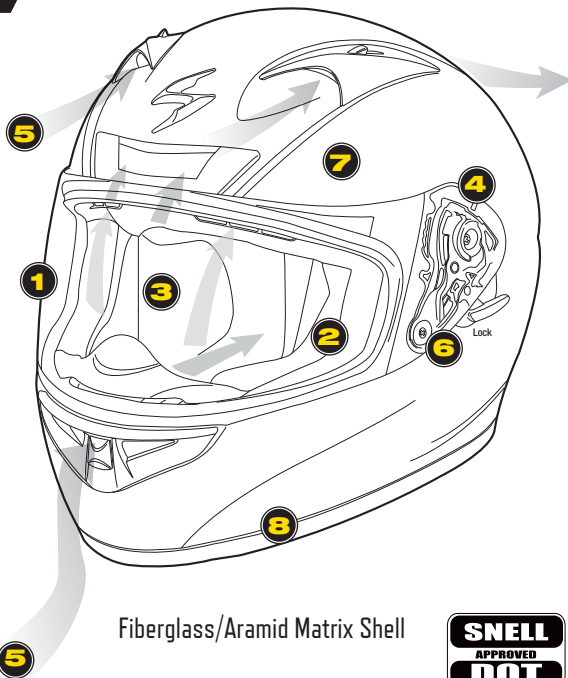

Fiberglass/Aramid Matrix Shell

## 8 Emergency Release System

Tabs located under the neck roll allow easy removal of the cheek pads by emergency medical personnel thus allowing easier removal of the helmet. (See page 7 for details and warning)



## Introduction



Congratulations for acquiring a premium ScorpionExo® helmet. This helmet embodies the latest, state-of-the-art design, engineering and technology available in the market today and is an excellent investment for your comfort and protection.

**Please remember that no helmet can protect you against all possible or foreseeable impacts even when built with the latest material and technology.**

The following information will help you to enjoy and properly care for your helmet.

## Function



A helmet's main function is to protect your head from impact in case of an accident. To accomplish this, a helmet surrounds your head with a matrix of materials designed to absorb and cushion impact energy in some accidents. A helmet is also designed to provide you with comfort while riding at speed and in various weather conditions. Yet, there is a trade-off: A helmet decreases hearing sensitivity, peripheral vision and physical movement to a certain extent while providing protection and comfort.

## Fit



It is important for maximum safety that your ScorpionExo® helmet fit snugly and comfortably on your head with the retention strap (chinstrap) properly and snugly fastened. With the chinstrap firmly fastened, grab the back of the helmet with both hands and try to roll the helmet forward. If you can roll the helmet over the eyes, it is too loose and you should try another size helmet.

## FaceShields



The faceshield on your ScorpionExo® helmet provides protection from weather, small flying objects and wind. Tinted shields are available to protect your eyes from excessive sunlight. The exclusive, patent-pending ScorpionExo™ “Ellip-Tec™” quick-change faceshield system allows you to easily change your shield in less than 10 seconds. See the instructions below in this manual.

**NEVER WEAR A DARK OR TINTED FACESHIELD IN DARK OR POOR VISIBILITY RIDING CONDITIONS.** This is not only unsafe, but also illegal in most states.

**NEVER WEAR A FACESHIELD THAT HAS BECOME SCRATCHED, OR RIDE WITH A FACESHIELD THAT IS FOGGED BY CONDENSATION. SCORPIONEXO™ FACESHIELDS (CLEAR AND SMOKE ONLY) COME WITH A SCRATCH-RESISTANT COATING.**

## Ventilation Systems



Ventilation systems are designed and engineered to maximize your comfort in a wide range of temperatures. Familiarize yourself with the vents on your street helmet. Some vents have detents allowing partial opening and closing, thereby controlling intake and exhaust airflow. Your helmet ventilation systems should be kept clear of any obstructions including dirt, insects or other items which could interfere with proper flow of air. The ventilation systems play an important role, especially during physical exertion or hot-weather riding. Ventilation helps decrease the possibility of fogging and condensation.

## Face Shield Lock/Vent Lever

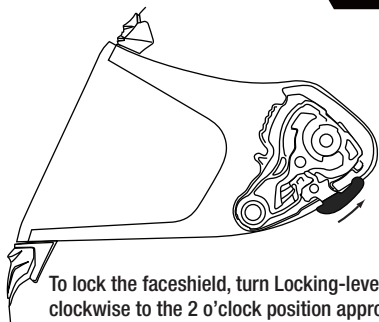

To lock the faceshield, turn Locking-lever counter clockwise to the 2 o'clock position approximately. Check face shield if it's securely locked.

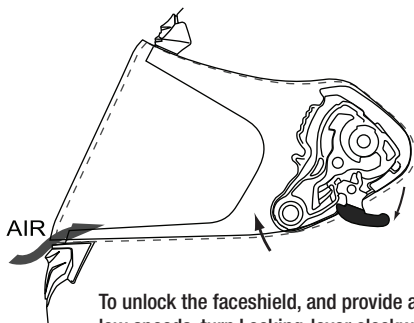

To unlock the faceshield, and provide air flow at low speeds, turn Locking-lever clockwise to the 5 o'clock position. Test faceshield to check if it is unlocked.

**Note: First, Close Shield to the lowest position to Lock/Unlock.**

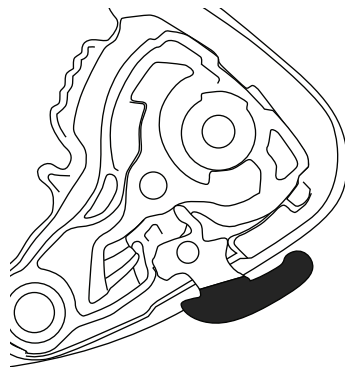

**Note: When the lever is positioned at 3 o'clock, the shield is closed, but it is also unlocked.**



**DO NOT ATTEMPT TO ADJUST WHILE RIDING**



## Cheek Pads Removal

Occasionally the cheek pads may require removal for washing or replacement.

First step: Remove the Aero Skirt.  
(refer to page 6).

Second step: Slide your thumb between the cheek pad and chin bar, gently tug.

Third step: Gently pull cheek pad away from inner chin bar to unsnap the three plastic clips.

Repeat this process for both cheek pads.

Once both cheek pads are removed you can also remove the crown liner component.  
(refer to page 5)

Reverse this process for installation.

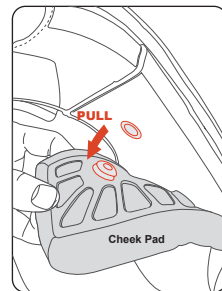
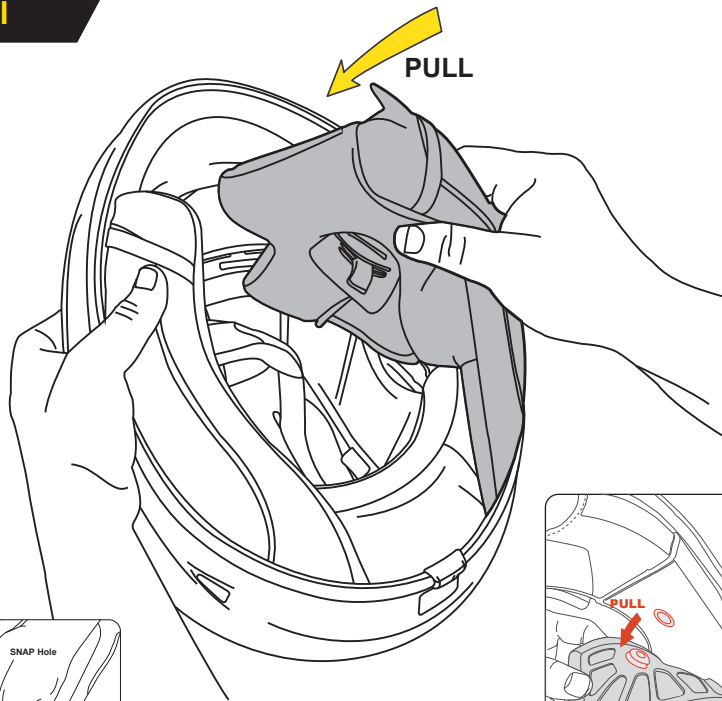
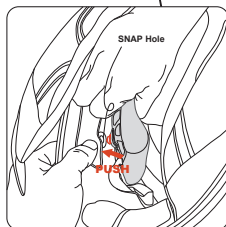

## Crown Liner Removal

Occasionally the crown liner may require removal for washing, replacement or to change sizes.

First step is to remove the Cheek Pads. (refer to page 4).

At the back of the helmet pull the crown liner away from the shell.

Pull the crown liner out of the helmet while gently detaching it from the forehead channel.

Reverse this process for installation.

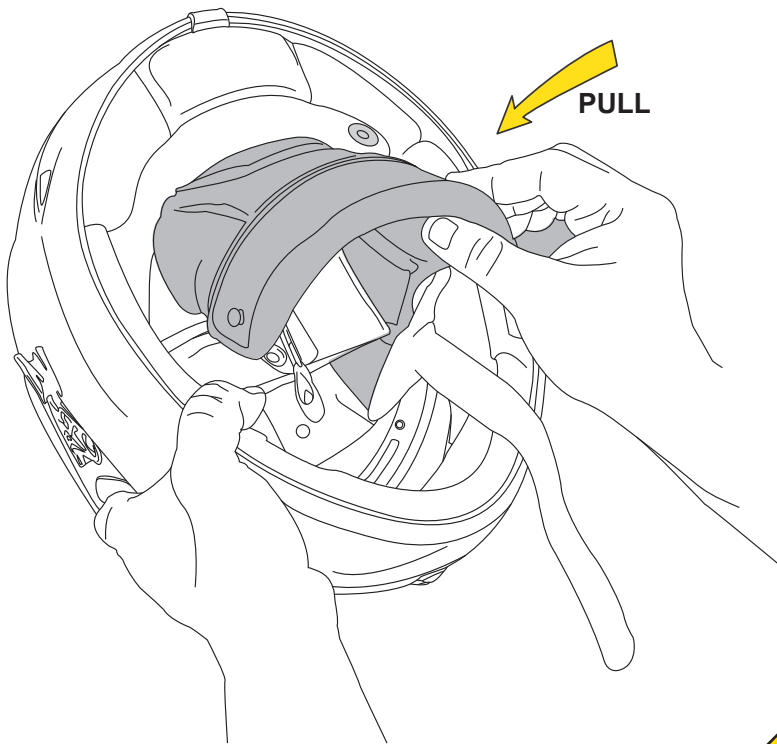

## Aero Skirt Removal

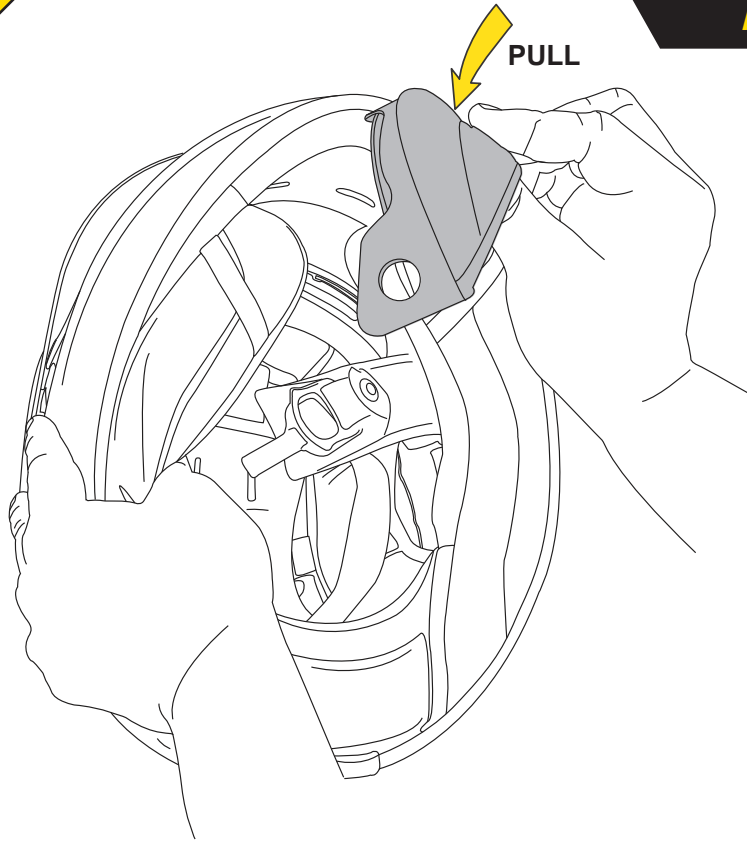

The pliable Aero Skirt was designed to reduce wind from entering behind the face shield area, specifically to keep your face warmer in cold weather.

You do however have the option to remove the Aero Skirt for cleaning or for warmer riding conditions.

### TO REMOVE

Simply tug on the Aero Skirt and it slides out of the rubber trim channel.

Reverse this process to re-install.

## Emergency Release System

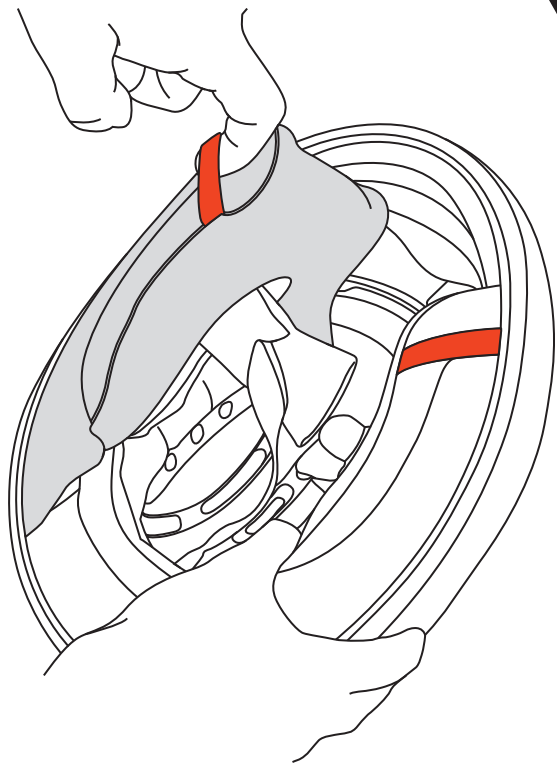

### Emergency Safety Release System

Locate the emergency labeling on the neck roll. Simply reach under the neck roll and grab the release strap, pull at a 45 degree angle towards front of helmet. The cheek liner will easily release from the helmet. This system should only be used by trained medical personnel.

**DO NOT ATTEMPT TO RELEASE WHILE RIDING**

**IN CASE OF ACCIDENT DO NOT ATTEMPT REMOVAL ON YOUR OWN**



## FaceShield Replacement

**NOTE: THE FACESHIELD CAN ONLY BE REMOVED OR INSTALLED WHEN IN THE FULLY OPENED POSITION!!!**

To remove your faceshield, place the helmet in front of you with the eye port facing away. Ratchet the faceshield up to the fully open position. Using both hands, push up the Y shape release latchet upward and the shield is able to release out of locking mechanism. Then, with both of your thumbs pushing squarely on the center of the Ellip-Tec™, gently pull or “peel” the faceshield away from the helmet.

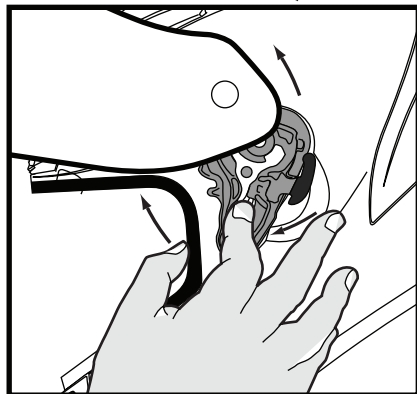

**IMPORT NOTE:**  
Be sure to latch up the “Y” release latchet while removing the faceshield!

## Securing and Wearing your Helmet

Do not simply pull your helmet down onto your head like a hat. Your Scorpion-Exo™ helmet should be worn as follows: Using both hands grab the helmet's bottom rim while holding the chin straps with your thumbs. Then “roll” the helmet onto your head starting at the forehead. Continue rolling the helmet on towards the back of the head until it comes to rest with your head fully in contact with the inner lining and cheek pads.

### HOW TO USE CHINSTRAP

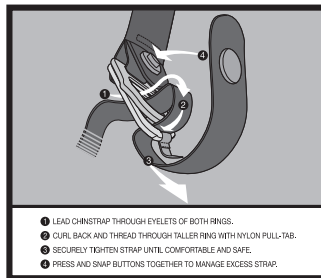

### FIRMLY AND SECURELY FASTEN YOUR CHINSTRAP.

Check your chinstrap for tightness occasionally as vibration or wind may loosen it.

### Cleaning Your Helmet System

None of the components of your ScorpionExo™ helmet can be damaged by water. All headliners and sweat-wicking cheek pads are machine washable. Wash them with a mild detergent in warm water and allow to air dry. Hand washing is recommended, but machine washing is also permitted. Use the “delicate” cycle to prevent the agitator from damaging the

Continued on pg. 9 >>

sweat-wicking material covering the liner parts. Do not place lining parts in the dryer: Excess heat may damage the foam and coverings. The faceshield may be cleaned with plastic polish or mild soap and water. The shell of your helmet should be cleaned using only a mild detergent and water. NEVER USE PETROLEUM BASED CHEMICALS, SOLVENTS, GASOLINE, CLEANING AGENTS OR ADHESIVES to clean the shell, liners or faceshield of your helmet. Your helmet shell, liner and faceshield may be seriously damaged by the use of such products.

## Warning



For your safety, it is important that you completely read the owner's manual and all warning labels.

## DO NOT



- DO NOT** ride without snugly fastening your chinstrap.
- DO NOT** clean your helmet with petroleum products, solvents, benzene, thinner or cleaning agents.
- DO NOT** paint over your helmet's finish without totally protecting and isolating the shock-absorbing liner and plastic parts. Your warranty will otherwise be invalidated.
- DO NOT** drop your helmet from any height onto a hard surface. This could cause damage to your helmet's finished and/or decrease its ability to protect you.
- DO NOT** place your helmet on your motorcycle's rearview mirror: The sharp pressure from the mirror's edge will compress and damage the helmet's shock-absorbing liner.
- DO NOT** place your helmet on the motorcycle's seat or fuel tank. It can easily roll off and hit the ground causing damage to the helmet. It is best to place your helmet on the ground so it cannot fall in any direction.

**DO NOT** ride with a scratched faceshield. This can impair your vision, especially at night.

**DO NOT** modify any part of your helmet, e.g., drilling the shell or cutting and pressing the shock absorbing liner. Installation of sound systems, speakers and microphones reduces your helmet's ability to protect you and is not recommended.

**DO NOT** use the helmet again if it has either been dropped or involved in an accident. Replace it even if the damage is not visible to the naked eye.

**DO NOT** wear a dark or tinted faceshield (including the retractable SpeedView™ Sunvisor) in dark or poor visibility riding conditions.

**DO NOT** place your headliners and cheek pads in the dryer after washing. Allow them to air dry.

**DO NOT** attempt to remove, change or replace your faceshield while riding your motorcycle or ATV.

**DO NOT** use paint which requires heat curing.

## Warranty



For on-line registration of your new ScorpionEXO helmet, please log onto [www.scorpionusa.com/support/product-registration.html](http://www.scorpionusa.com/support/product-registration.html). Should you have a warranty claim, please call 888-672-6774 or email [warranty@scorpionusa.com](mailto:warranty@scorpionusa.com) during business hours (PST). Details of your ScorpionEXO warranty can be found online: [www.scorpionusa.com/support/warranty-and-returns.html](http://www.scorpionusa.com/support/warranty-and-returns.html)

**YEAR**  
**5**  
**WARRANTY**

## FOLLOW US ON OUR SOCIAL NETWORKS



Like us on Facebook for a chance to win Scorpion products:  
<https://www.facebook.com/ScorpionExoUSA>



Follow us on Twitter to be the first to know about new products :  
<https://twitter.com/ScorpionExo>



Subscribe to our YouTube page for fresh videos on our latest products:  
<http://www.youtube.com/user/ScorpionNation>



Follow us on Instagram for a visual look into the Scorpion nest:  
Search user @Scorpionexo or #scorpionexo

Scan to visit our website:





**EXO-R710**  
**TECHMANUAL**



**ScorpionEXO Warranty/Tech Center**  
**10425 Slusher Drive**  
**Santa Fe Springs, CA 90670.USA**  
**T: 1.888.672.6774**  
**E: [warranty@scorpionusa.com](mailto:warranty@scorpionusa.com)**

Printed in China