

EXO-CT220

SCORPION
EXO

TECHMANUAL

EXO-CT220 Performance Features

1 SpeedView® SunVisor

Retractable interchangeable internal sun visor. Choose the position that best suits you with the flip of a switch. Up to 3 different positions to choose from.

2 KwikWick II® Liner Fabric

KwikWick II® anti-microbial fabric keeps you cool and dry in warm weather, warm in cool weather. Liner is easily removable and washable.

3 Quick Change Ratchet System

Easy, Secure, tool-less faceshield changes in seconds.

4 Aero-Tuned Ventilation

Two intake ports across the front of helmet forces cool air in while two exhaust vents maximize movement of hot air out.

5 KwikFit™

KwikFit™ cheekpads allow easy on and off of the most common styles of eye glasses

6 Advanced Dual-Density EPS:

Advanced multi-layer EPS provides efficient energy displacement in key areas.

7 Emergency Release System

Tabs located on the cheek pads allow easy removal of the cheek pads by emergency medical personnel thus allowing easier removal of the helmet.

8 Face Shield Lock

Shield locks in place when pressed firmly into the closed position.

9 Wind Reduction Shield

Advance shield design allows for a reduction in wind turbulence near the face.

10 Speaker Pockets

Cheek pads feature a convenient pocket for your speaker devices.

11 Anti-Roll-Off System

Ensures chinstrap is correctly adjusted and reduces helmet from pivoting off the head.

12 Peak Visor

Peak visor allows you to quickly switch from a full-face shield to a ¾ open face helmet.

PEAKVISOR
INCLUDED

100% LV
A and B PROTECTION

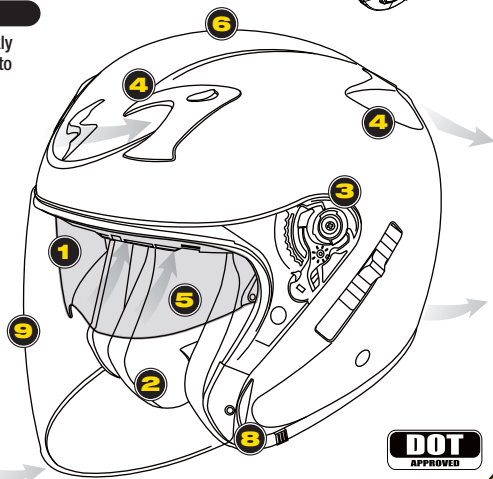
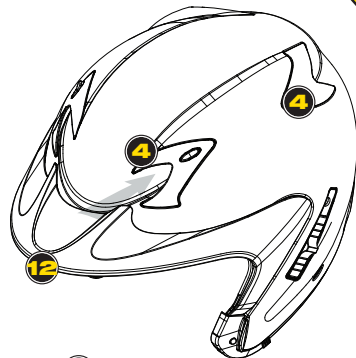

DOT
APPROVED

Introduction



Congratulations for acquiring a premium ScorpionExo® helmet. This helmet embodies the latest, state-of-the-art design, engineering and technology available in the market today and is an excellent investment for your comfort and protection.

Please remember that no helmet can protect you against all possible or foreseeable impacts even when built with the latest material and technology.

The following information will help you to enjoy and properly care for your helmet.

Function



A helmet's main function is to protect your head from impact in case of an accident. To accomplish this, a helmet surrounds your head with a matrix of materials designed to absorb and cushion impact energy in some accidents. A helmet is also designed to provide you with comfort while riding at speed and in various weather conditions. Yet, there is a trade-off: A helmet decreases hearing sensitivity, peripheral vision and physical movement to a certain extent while providing protection and comfort.

Fit



It is important for maximum safety that your ScorpionExo® helmet fit snugly and comfortably on your head with the retention strap (chinstrap) properly and snugly fastened. With the chinstrap firmly fastened, grab the back of the helmet with both hands and try to roll the helmet forward. If you can roll the helmet over the eyes, it is too loose and you should try another size helmet.

FaceShields



The faceshield on your ScorpionExo® helmet provides protection from weather, small flying objects and wind. Tinted shields are available to protect your eyes from excessive sunlight. The ScorpionExo® quick-change faceshield system allows you to easily change your shield in less than 10 seconds. See the instructions below in this manual.

NEVER WEAR A DARK OR TINTED FACESHIELD IN DARK OR POOR VISIBILITY RIDING CONDITIONS. This is not only unsafe, but also illegal in most states.

NEVER WEAR A FACESHIELD THAT HAS BECOME SCRATCHED, OR RIDE WITH A FACESHIELD THAT IS FOGGED BY CONDENSATION. SCORPIONEXO™ FACESHIELDS (CLEAR AND SMOKE ONLY) COME WITH A SCRATCH-RESISTANT COATING.

Ventilation Systems



Ventilation systems are designed and engineered to maximize your comfort in a wide range of temperatures. Familiarize yourself with the vents on your street helmet. Some vents have detents allowing partial opening and closing, thereby controlling intake and exhaust airflow. Your helmet ventilation systems should be kept clear of any obstructions including dirt, insects or other items which could interfere with proper flow of air. The ventilation systems play an important role, especially during physical exertion or hot-weather riding. Ventilation helps decrease the possibility of fogging and condensation.

Face Shield Lock

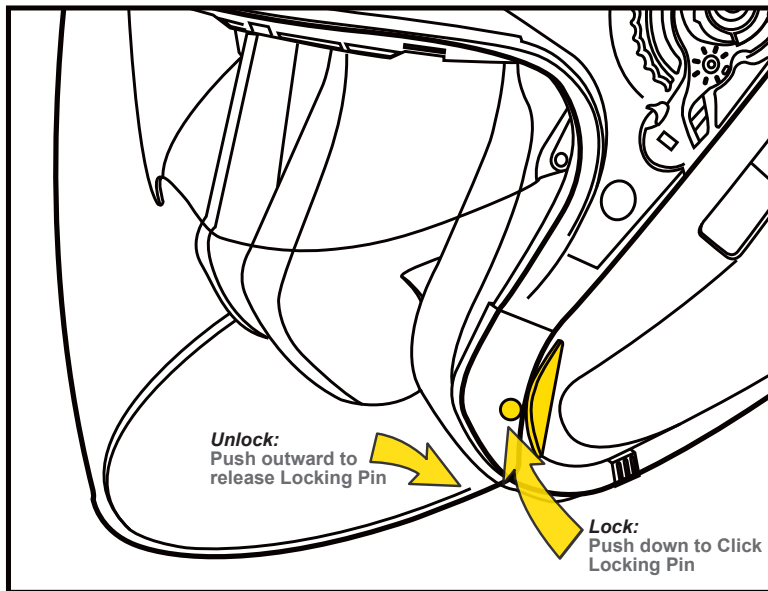

To **lock** the faceshield, securely push down causing the shield to lift over the locking pin.

To **unlock** the faceshield, firmly press the bottom of the shield out and up, this will lift the shield over the locking pin.

/// DO NOT ATTEMPT TO LOCK OR UNLOCK YOUR SHIELD WHILE RIDING ///

Cheek Pads Removal

Occasionally the cheek pads may require removal for washing or replacement.

Slide your thumb between the cheek pad and the shell of the helmet, gently tug inward.

Repeat this process for both cheek pads.

Once both cheek pads are removed you can also remove the crown liner component.

Reverse this process for installation.

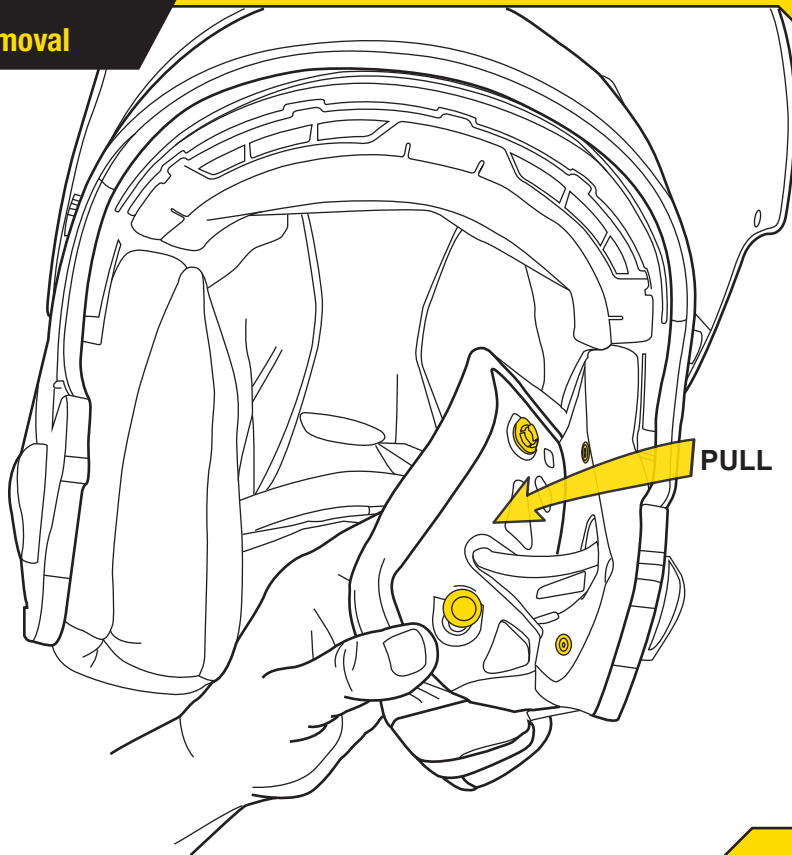

Crown Liner Removal

Occasionally the crown liner may require removal for washing, replacement or to change sizes.

First step is to remove the Cheek Pads. (refer to page 4).

At the back of the helmet pull the crown liner away from the shell.

Pull the crown liner out of the helmet while gently detaching it from the forehead channel.

Reverse this process for installation.

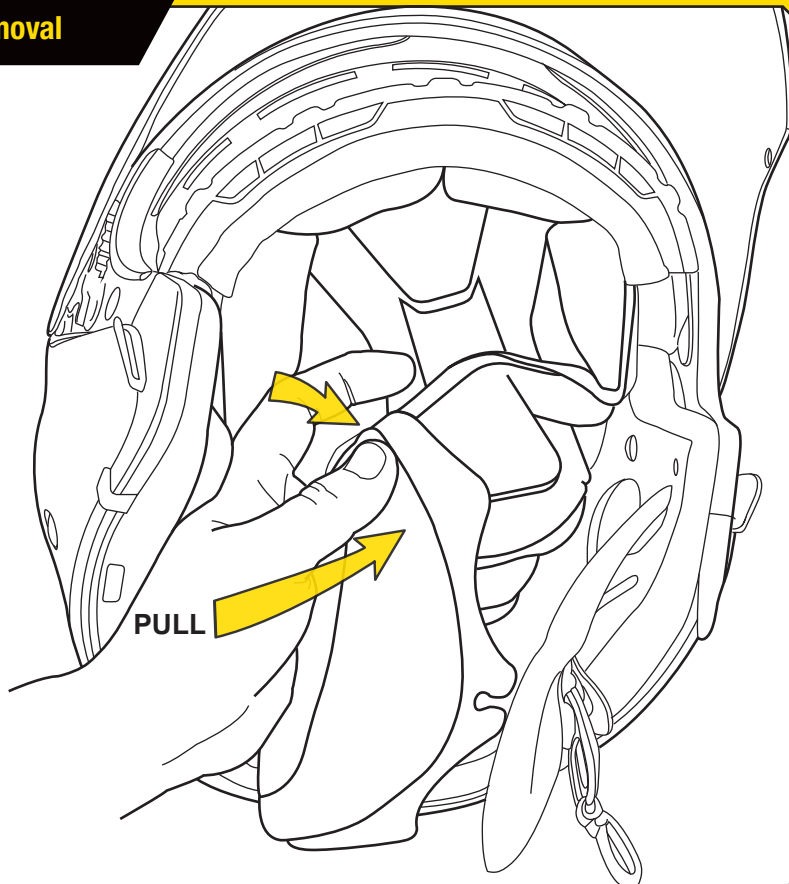

Peak Visor Install

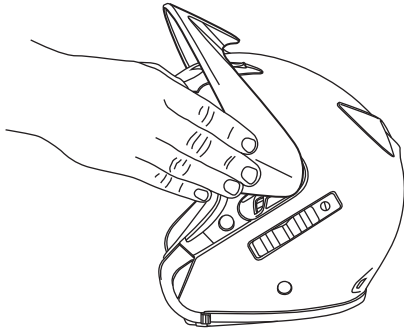

1

With the peak visor in the open position, align the arrows located on the outer edge of the peak visor and baseplate unit. Firmly press down to secure the peak visor to the baseplate. Perform this on both sides of the helmet.

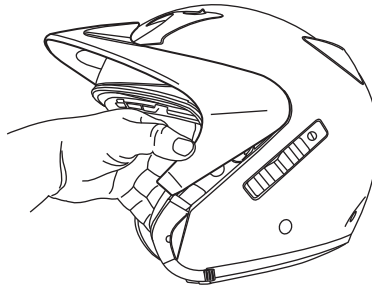

2

Once both sides of the peak visor are snapped into place, move the peak to the closed position. A locking screw is located on the inside of the peak visor. To ensure this screw sits to the inside of the baseplate you will need to press the peak visor in towards the helmet while closing.

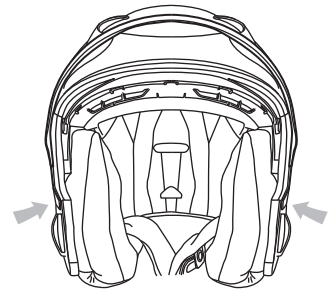

3

Verify the peak is sitting flush to the shell when in the fully closed position. If the peak visor is not sitting flush when closed then re-open the peak and re-peat step 2.

Emergency Release System

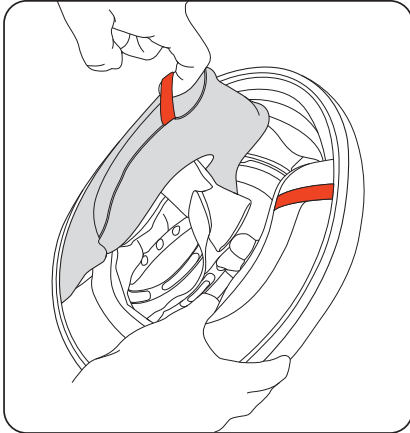

Emergency Safety Release System

Locate the emergency labeling on the cheek pads. Simply grab the release strap, pull at a 45 degree angle towards front of helmet. The cheek liner will easily release from the helmet. **This system should only be used by trained medical personnel.**

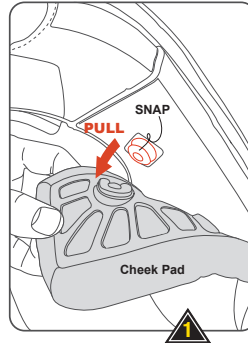

1

SNAP

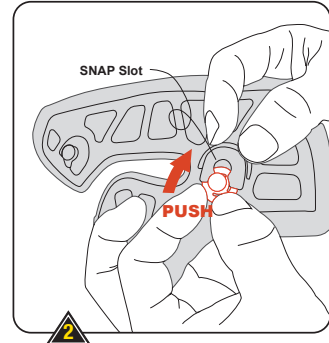

2

PRECAUTION

1. SNAP may come off from the Cheek Pad during Cheek Pad removal.
2. Locate the separated SNAP and reassemble on to the Cheek Pad by pushing the SNAP into the SNAP Slot on the Cheek Pad.
3. Align SNAP on the Cheek Pad to the SNAP Hole and push the snap in until sound is heard.

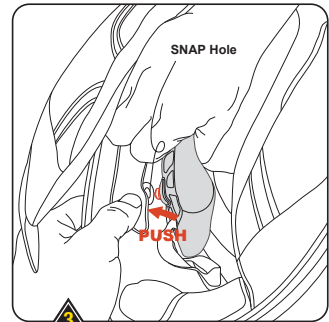

3

DO NOT ATTEMPT TO RELEASE WHILE RIDING

IN CASE OF ACCIDENT DO NOT ATTEMPT REMOVAL ON YOUR OWN

FaceShield Replacement

NOTE: THE FACESHIELD CAN ONLY BE REMOVED OR INSTALLED WHEN IN THE FULLY OPENED POSITION!!!

To remove your faceshield, place the helmet in front of you with the eye port facing away. Ratchet the faceshield up to the fully open position. Using both hands, push up the Y shape release lever upward releasing the locking mechanism. Then, gently pull or “peel” the faceshield away from the helmet.

QUICK CHANGE RATCHETING SYSTEM

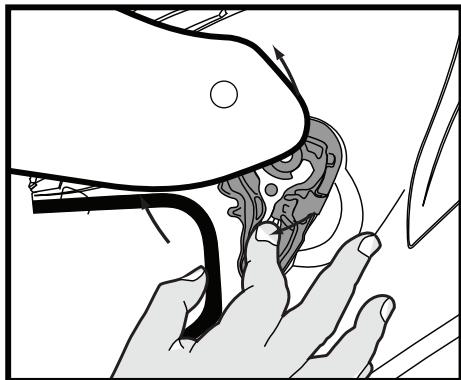

IMPORT NOTE:
Be sure to latch up the “Y” release latchet while removing the faceshield!

Securing and Wearing your Helmet

Do not simply pull your helmet down onto your head like a hat. Your Scorpion-Exo™ helmet should be worn as follows: Using both hands grab the helmet's bottom rim while holding the chin straps with your thumbs. Then “roll” the helmet onto your head starting at the forehead. Continue rolling the helmet on towards the back of the head until it comes to rest with your head fully in contact with the inner lining and cheek pads.

HOW TO USE CHINSTRAP

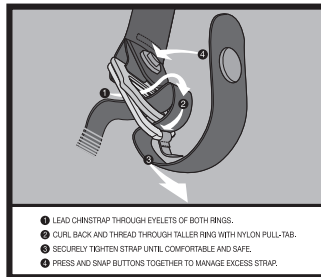

FIRMLY AND SECURELY FASTEN YOUR CHINSTRAP.

Check your chinstrap for tightness occasionally as vibration or wind may loosen it.

Cleaning Your Helmet System

None of the components of your ScorpionExo™ helmet can be damaged by water. All headliners and sweat-wicking cheek pads are machine washable. Wash them with a mild detergent in warm water and allow to air dry. Hand washing is recommended, but machine washing is also permitted. Use the “delicate” cycle to prevent the agitator from damaging the

Continued on pg. 9 >>

sweat-wicking material covering the liner parts. Do not place lining parts in the dryer: Excess heat may damage the foam and coverings. The faceshield may be cleaned with plastic polish or mild soap and water. The shell of your helmet should be cleaned using only a mild detergent and water. NEVER USE PETROLEUM BASED CHEMICALS, SOLVENTS, GASOLINE, CLEANING AGENTS OR ADHESIVES to clean the shell, liners or faceshield of your helmet. Your helmet shell, liner and faceshield may be seriously damaged by the use of such products.

Warning



For your safety, it is important that you completely read the owner's manual and all warning labels.

DO NOT



- DO NOT** ride without snugly fastening your chinstrap.
- DO NOT** clean your helmet with petroleum products, solvents, benzene, thinner or cleaning agents.
- DO NOT** paint over your helmet's finish without totally protecting and isolating the shock-absorbing liner and plastic parts. Your warranty will otherwise be invalidated.
- DO NOT** drop your helmet from any height onto a hard surface. This could cause damage to your helmet's finished and/or decrease its ability to protect you.
- DO NOT** place your helmet on your motorcycle's rearview mirror: The sharp pressure from the mirror's edge will compress and damage the helmet's shock-absorbing liner.
- DO NOT** place your helmet on the motorcycle's seat or fuel tank. It can easily roll off and hit the ground causing damage to the helmet. It is best to place your helmet on the ground so it cannot fall in any direction.

DO NOT ride with a scratched faceshield. This can impair your vision, especially at night.

DO NOT modify any part of your helmet, e.g., drilling the shell or cutting and pressing the shock absorbing liner. Installation of sound systems, speakers and microphones reduces your helmet's ability to protect you and is not recommended.

DO NOT use the helmet again if it has either been dropped or involved in an accident. Replace it even if the damage is not visible to the naked eye.

DO NOT wear a dark or tinted faceshield (including the retractable SpeedView™ Sunvisor) in dark or poor visibility riding conditions.

DO NOT place your headliners and cheek pads in the dryer after washing. Allow them to air dry.

DO NOT attempt to remove, change or replace your faceshield while riding your motorcycle or ATV.

DO NOT use paint which requires heat curing.

Warranty



For on-line registration of your new ScorpionEXO helmet, please log onto www.scorpionusa.com/support/product-registration.html. Should you have a warranty claim, please call 888-672-6774 or email warranty@scorpionusa.com during business hours (PST). Details of your ScorpionEXO warranty can be found online: www.scorpionusa.com/support/warranty-and-returns.html

YEAR
5
WARRANTY

FOLLOW US ON OUR SOCIAL NETWORKS



Like us on Facebook for a chance to win Scorpion products:
<https://www.facebook.com/ScorpionExoUSA>



Follow us on Twitter to be the first to know about new products :
<https://twitter.com/ScorpionExo>



Subscribe to our YouTube page for fresh videos on our latest products:
<http://www.youtube.com/user/ScorpionNation>



Download our FREE iPhone/iPad App. available on the App Store:
<http://itunes.apple.com/us/app/scorpionexo/id429393136?mt=8>



Follow us on Instagram for a visual look into the Scorpion nest:
Search user @Scorpionexo or #scorpionexo

Scan to visit our website:





EXO-CT220
TECHMANUAL



ScorpionEXO Warranty/Tech Center
10425 Slusher Drive
Santa Fe Springs, CA 90670.USA
T: 1.888.672.6774
E: warranty@scorpionusa.com

Printed in China