

EXO-AT950 SNOW



EXO-AT950
TECHMANUAL



SCORPION
EXO

TECHMANUAL

Printed in China



EXO-AT950 SNOW

PERFORMANCE FEATURES

1 Aero-Tuned Peak Visor



Removable aero-tuned peak visor. Designed and optimized for maximum airflow and mobility.

2 SpeedView® Retractable Sun-Visor



Retractable internal sun visor changes positions with a simple slide of a switch.

3 Anti-Fog Shield for Snow Riding

Dual lens are applied for optimal anti-fog treatment. The shield is also anti-scratch coated and UV protected. City-Mode tab allows the shield to be locked or left slightly open for a gentle flow of air. Both standard version and electric version are available.

4 KwikWick® II Washable Anti-Microbial Comfort Liner

Scorpion's moisture-wicking lining material feels cool to the touch in warm weather and warm in cool weather while maintaining anti-microbial and hypo-allergenic properties



5 KwikFit® Cheek Pads



Kwikfit™ cheek pads allow easy on and off of the most common styles of eye glasses.

6 Flip-up Chin Bar

A single button release allows the chin bar to be raised or lowered with ease for either hand.

7 Aero-Tuned Ventilation System

Intake ports across the front of the helmet force cool air into the helmet interior while exhaust vents maximize movement of hot air out of the helmet.

8 Side Covers

Side covers are bundled to provide a perfect full-face look.

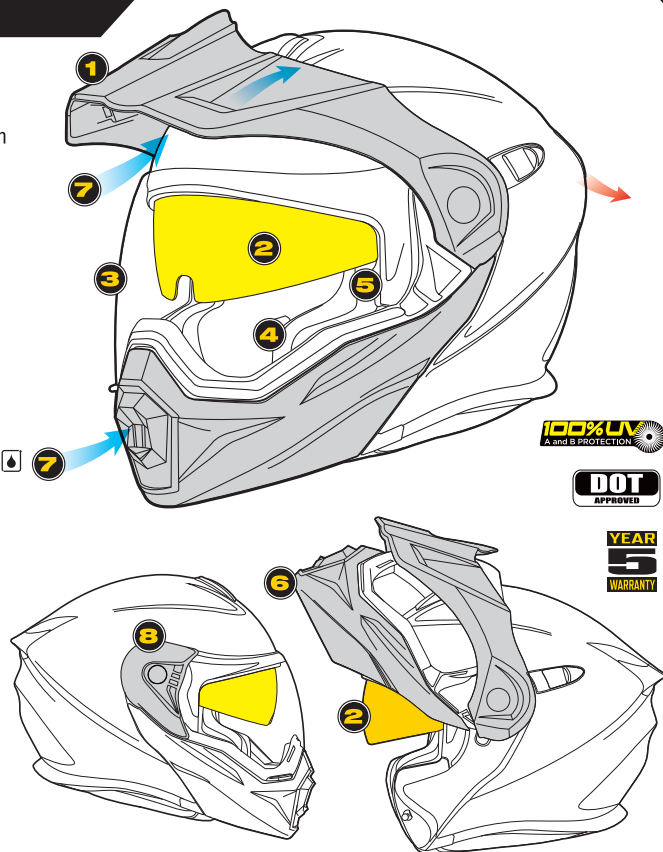

Introduction



Congratulations for acquiring a premium ScorpionExo® helmet. This helmet embodies the latest, state-of-the-art design, engineering and technology available in the market today and is an excellent investment for your comfort and protection.

Please remember that no helmet can protect you against all possible or foreseeable impacts even when built with the latest and best materials and technology.

The following information will help you to enjoy and properly care for your helmet.

Function



A helmet's main function is to protect your head from impact in case of an accident. To accomplish this, a helmet surrounds your head with a matrix of materials designed to absorb and cushion impact energy in some accidents. A helmet is also designed to provide you with comfort while riding at speed and in various weather conditions. Yet, there is a trade-off: A helmet decreases hearing sensitivity, peripheral vision and physical movement to a certain extent while providing protection and comfort.

Fit



It is important for maximum safety that your ScorpionExo® helmet fit snugly and comfortably on your head with the retention strap (chinstrap) properly and snugly fastened. With the chinstrap firmly fastened, grab the back of the helmet with both hands and try to roll the helmet forward. If you can roll the helmet over the eyes, it is too loose and you should try another size of helmet.

FaceShields



The faceshield on your ScorpionExo® helmet provides protection from weather, small flying objects and wind. Tinted shields are available to protect your eyes from excessive sunlight. The ScorpionExo® SpeedView® internal sunvisor system allows you to instantly tint the sunlight.

WARNING

NEVER USE A DARK OR TINTED FACESHIELD OR SPEEDVIEW VISOR IN DARK OR POOR VISIBILITY RIDING CONDITIONS. This is not only unsafe, but also illegal in most countries.

NEVER WEAR A FACESHIELD THAT HAS BECOME SCRATCHED, OR RIDE WITH A FACESHIELD THAT IS FOGGED BY CONDENSATION. SCORPIONEXO® FACESHIELDS (CLEAR AND SMOKE ONLY) COME WITH A SCRATCH-RESISTANT COATING.

Ventilation Systems



Ventilation systems are designed and engineered to maximize your comfort in a wide range of temperatures. Familiarize yourself with the vents on your street helmet. Some vents have detents allowing partial opening and closing, thereby controlling intake and exhaust airflow. Your helmet ventilation systems should be kept clear of any obstructions including dirt, insects or other items which could interfere with proper flow of air. The ventilation systems play an important role, especially during physical exertion or hot-weather riding. Ventilation helps decrease the possibility of fogging on the faceshield.

FRONT VIEW OF THE HELMET

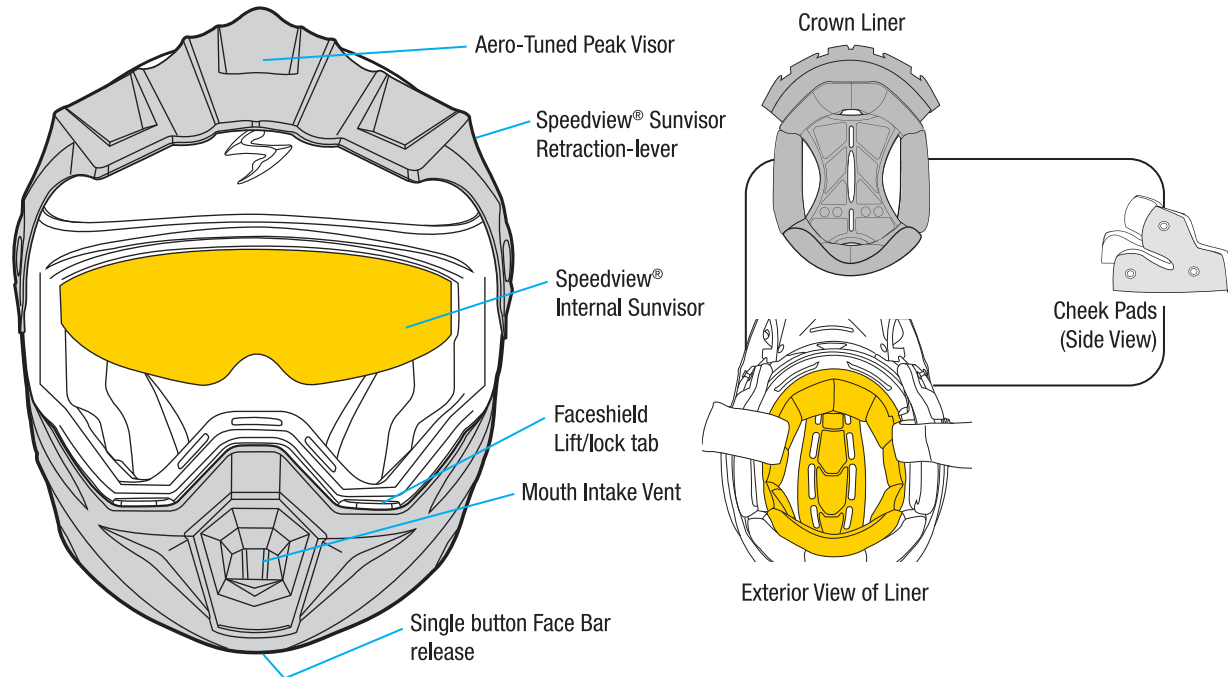

⚠ WARNING

Always check to make sure the crown liner, neckroll and cheek pad are installed before using the helmet. A helmet without the crown liner and/or cheekpad may increase your risk of serious injury or death.

USING THE RETRACTABLE SPEEDVIEW® SUNVISOR

NOTE: THE RETRACTABLE INTERNAL SUNVISOR CAN BE LOWERED AND RETRACTED, REGARDLESS OF WHETHER OR NOT THE FACESHIELD IS UP OR DOWN.

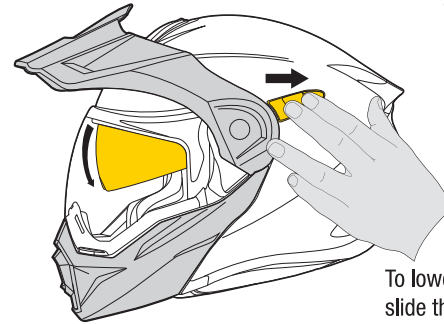

To lower the sunvisor, simply slide the SpeedView® Sunvisor Retraction-lever towards the back of the helmet.

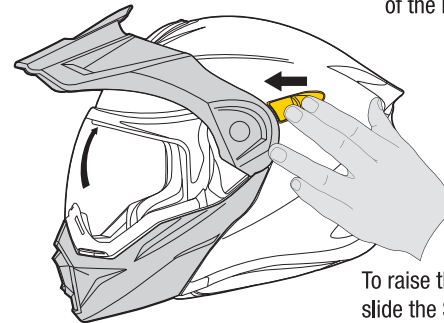

To raise the sunvisor, just slide the SpeedView® Sunvisor Retraction-lever towards the front of the helmet.

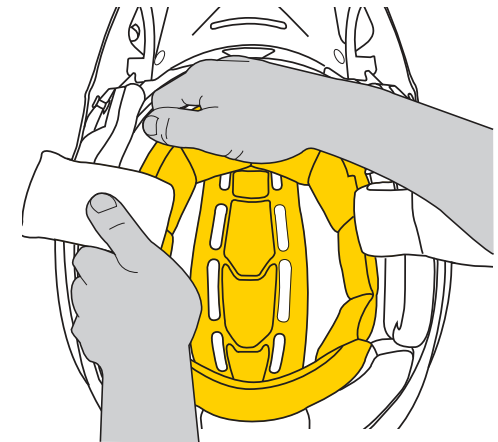

REMOVING THE CHEEKPADS

Gently pull cheek pads away from the interior wall of helmet to unsnap the plastic clips on each side. Next, gently tug away the cheek pads from helmet.

/// DO NOT ATTEMPT TO ADJUST WHILE RIDING ///

REMOVING THE SIDE COVERS

To remove the side covers, first make sure chin bar is closed. Then twist off each of the 2 peak visor screws from both sides. Gently lift off helmet.

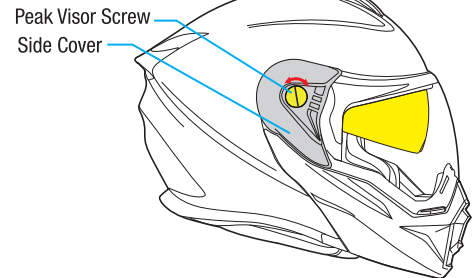

INSTALL THE SIDE COVERS

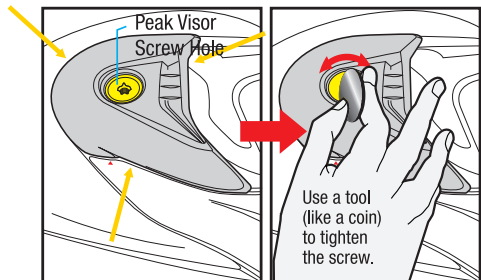

To install the side covers, first remove the peak visor. Then align each side cover over the faceshield side (see yellow arrows) and with the peak visor screw hole. Insert peak visor screws into each side and firmly tighten both sides by a tool like a coin.

⚠ WARNING

Make sure the **plastic washers** are in right place before you fasten the peak visor screws. The screws can be loosened easily without plastic washers, and may cause dangerous situation.

INSTALL/REMOVE THE PEAK VISOR

To install the peak visor, align the visor in the upright position and line-up the arrows on the chin bar and peak visor (circled in red). Insert peak visor screws into each side and firmly tighten both sides by a tool like a coin. Reverse the process to remove the peak visor.

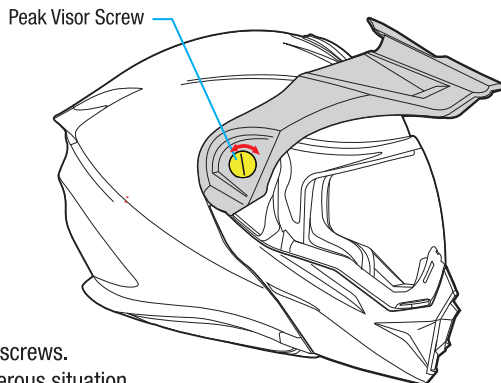
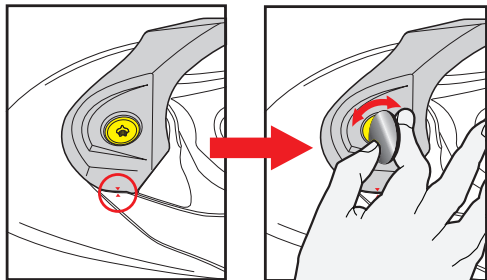

REMOVAL OF SPEEDVIEW® SUNVISOR FOR CLEANING OR REPLACEMENT

NOTE: FIRST, OPEN OUTER SHIELD TO THE HIGHEST POSITION. THEN LOWER THE SUNVISOR TO LOWEST POSSIBLE POSITION.

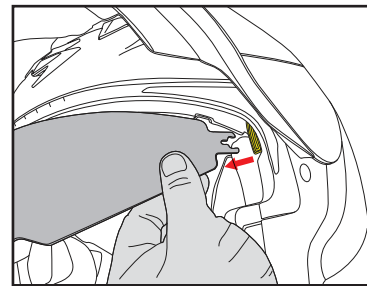

Firmly hold the sunvisor with your hand and gently pull one side out away from the helmet to release. Repeat to release the opposite side.

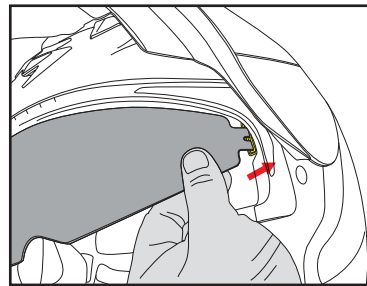

Reverse process for installation.

REMOVING THE CROWN LINER

After removing the cheek pads, reach into the helmet and pull out the crown liner shown below. The front part of the liner is snapped to the helmet liner frame. Gently detach it from the forehead channel and pull away from interior of helmet.

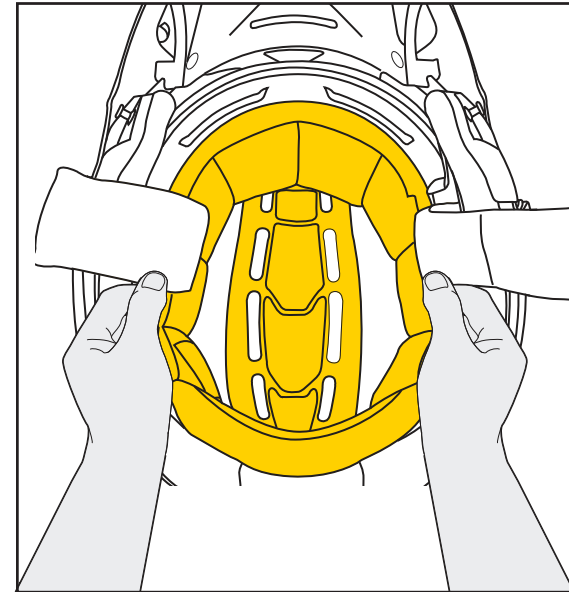

OPERATION OF FLIP UP CHIN BAR

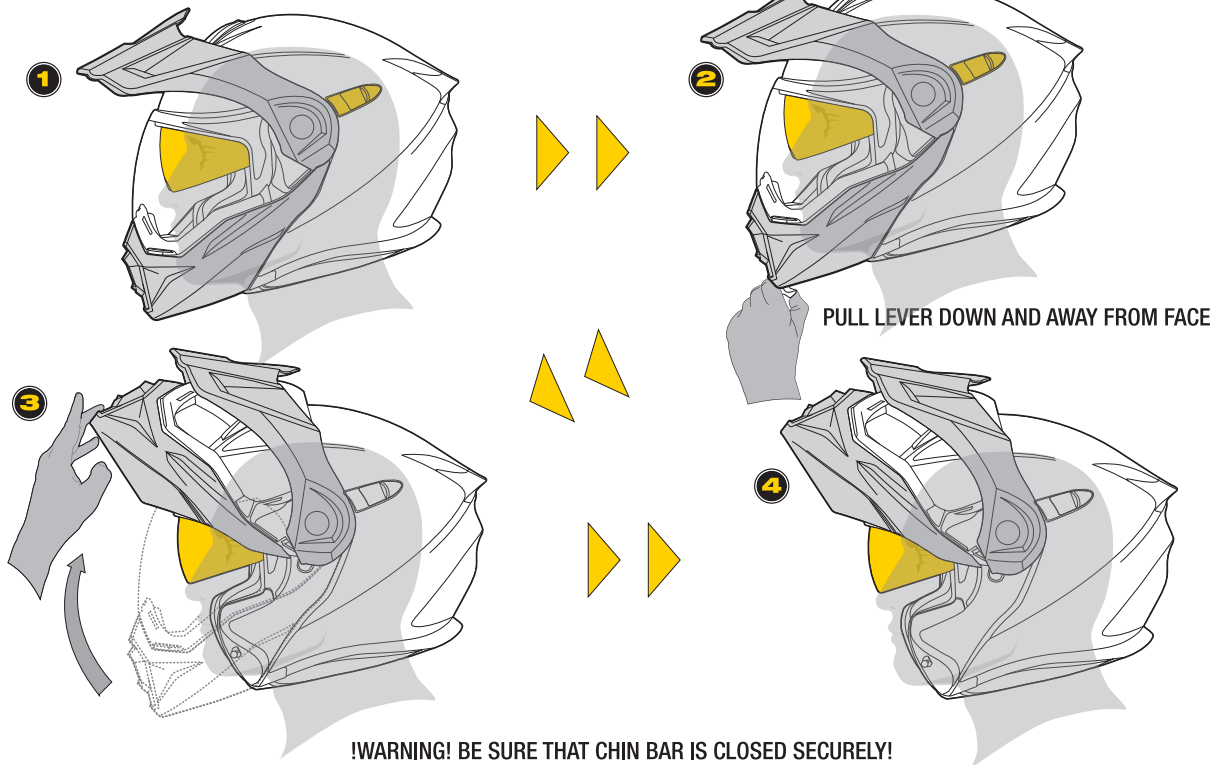

**!WARNING! BE SURE THAT CHIN BAR IS CLOSED SECURELY!
DO NOT OPERATE MOTORCYCLE WITH CHIN BAR IN OPEN POSITION!**

/// DO NOT ATTEMPT TO ADJUST WHILE RIDING ///

INSTALLATION OF BREATH BOX

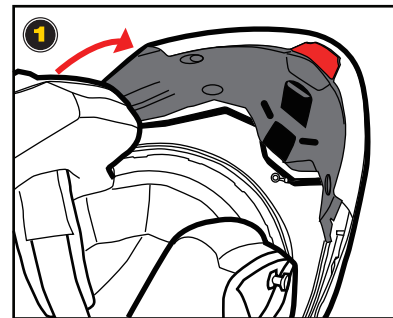

First, place the helmet upside down, then slightly open the chin bar.

Note: The helmet should be placed on a helmet pad or a soft and smooth surface to avoid any scratch or damage.



Second, insert the tab of the breath box into the hole inside the chin bar (as seen in the red circle).

After inserting the tab, push the flat side of the tab until you hear it "click" into position.

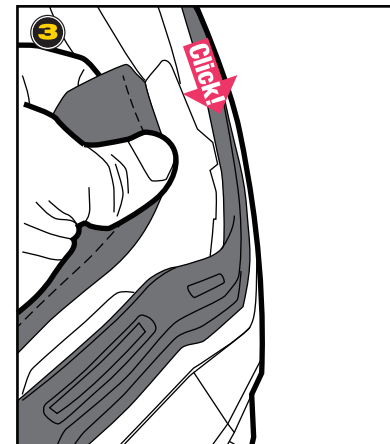

Third, insert the side mounting tab (refer to the red arrow) under the rubber gasket on the top surface of the chin bar.

Once the side mounting tab on one side is correctly seated, repeat this process on the other side to completely install the breath box. Reverse these steps in order to remove the breath box.

INSTALLING THE CHIN CURTAIN

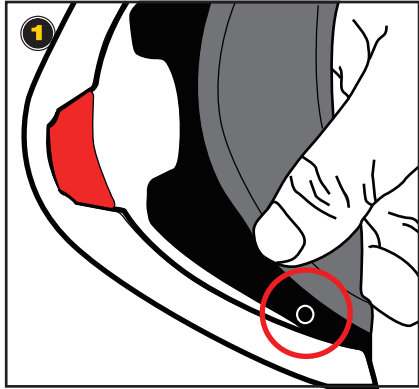

Insert the hole (in red circle) to the post hidden inside the lower edge of the chin bar.

Do the same to the other side to completely install the chin curtain.

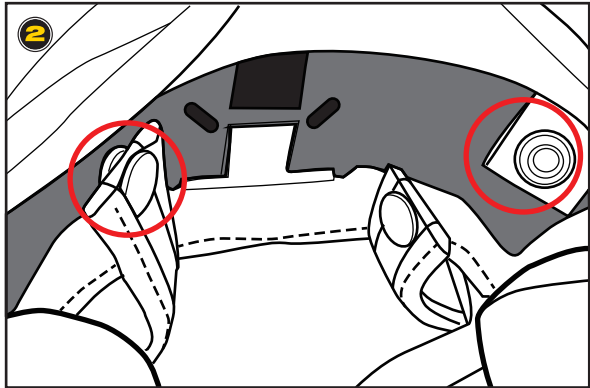

After installing the chin curtain, connect the chin curtain to the breath box by the snaps (in red circles) . Do these steps in reverse order to remove.

If you want to use the breath box or the chin curtain separately, you can do it referring to the above instructions.

INSTALLING THE ELECTRIC SHIELD*

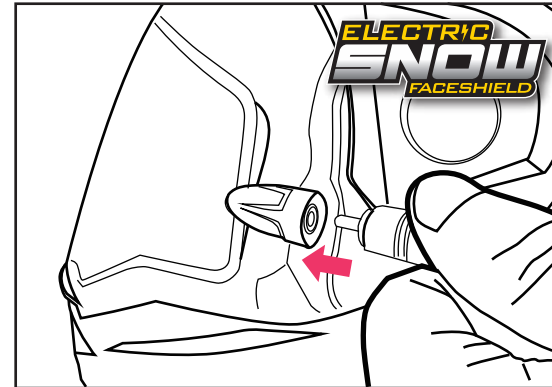

*Note: This instruction is for the EXO-AT950 Snow Electric Shield Version. The helmet is also available with a standard dual pane shield.

1. Connect RED wire of the power cord to the POSITIVE (+) battery terminal.
2. Connect BLACK wire of the power cord to the NEGATIVE (-) battery terminal.
3. Plug the power cord jack into the female jack connection.
4. Never use power sources above 15 Volts @2 AMPS, as this may damage the heating elements.

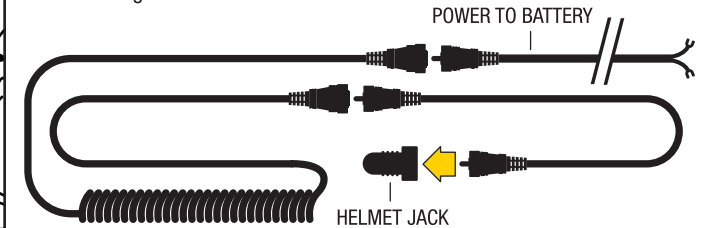

Easily connect your electric faceshield to the accessory outlet!

Ask your retailer about the Electric Faceshield Jack accessory.

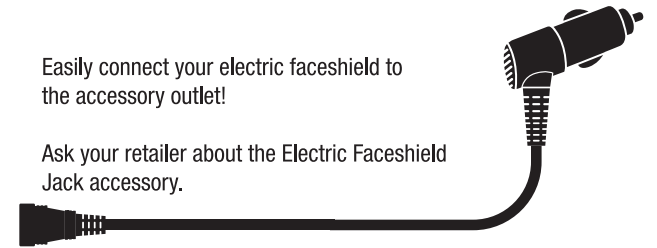

MOUTH VENT DOOR LEVER (INSIDE OF CHIN BAR)

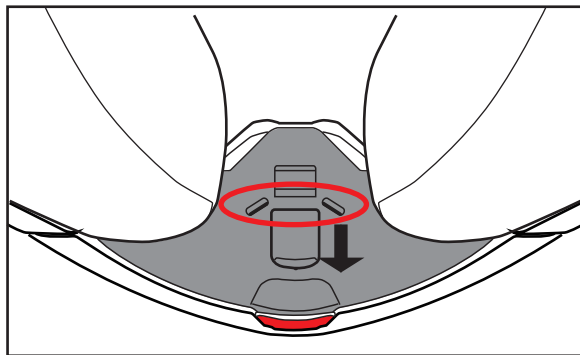

When you ride in cold weather, you may need to open/close the mouth vent (chin vent) to remove fog caused from breath or sweat.

To open the vent hole, simply slide the vent door lever down.

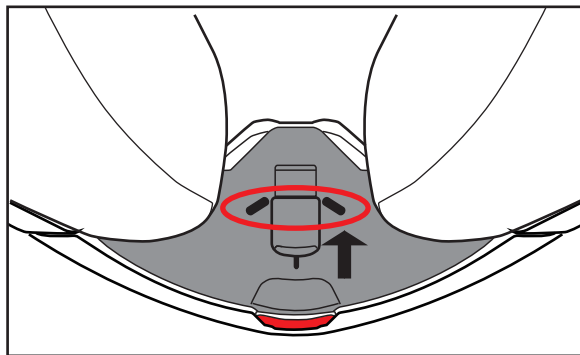

To close the vent hole, simply slide the vent door lever up.

NOTE: BEFORE YOU RIDE, CHECK THE MOUTH VENT TO SEE WHETHER THE VENT DOOR IS IN YOUR PREFERRED POSITION.

FACESHIELD REPLACEMENT

To remove your faceshield, first you will need to remove the peak visor. See page 5 for detail. Once the peak visor is off. Remove the faceshield one side at a time. Replace with new one.

To remove the peak visor (or side covers), first make sure chin bar is closed. Then twist off each of the 2 peak visor screws from both sides. Gently lift off helmet.

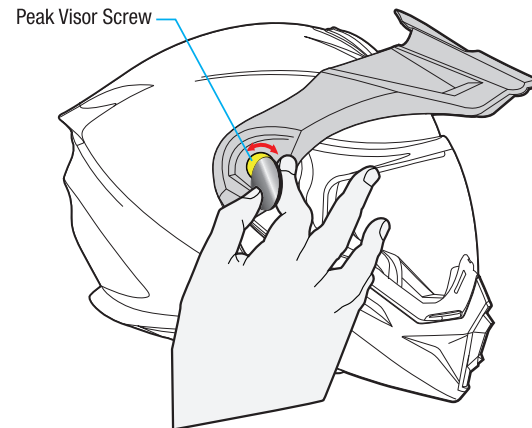

Once the new faceshield is in position, re-install the peak visor or side covers. See page 5 for details.

SECURING AND WEARING YOUR HELMET

Do not simply pull your helmet down onto your head like a hat. Your helmet should be worn as follows: Using both hands grab the helmet's bottom rim while holding the chin straps with your thumbs. Then "roll" the helmet onto your head starting at the forehead. Continue rolling the helmet on towards the back of the head until it comes to rest with your head fully in contact with the inner lining and cheek pads.

HOW TO USE CHINSTRAP

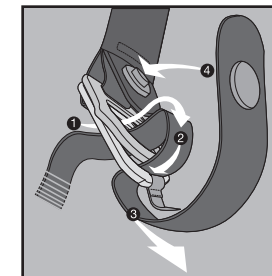

- 1) Lead chinstrap through eyelets of both rings.
- 2) Curl back and thread through taller ring with nylon pull-tab.
- 3) Securely tighten chinstrap until comfortable and safe.
- 4) Press and snap buttons together to manage excessive strap.

FIRMLY AND SECURELY FASTEN YOUR CHINSTRAP.

Check your chinstrap for tightness occasionally as vibration or wind may loosen it.

Cleaning Your Helmet System

None of the components of your helmet can be damaged by water. All headliners and sweat-wicking cheek pads are machine washable. Wash them with a mild detergent in warm water and allow to air dry. Hand washing is recommended, but machine washing is also permitted. Use the "delicate" cycle to prevent the agitator from

damaging the sweat-wicking material covering the liner parts, we recommend to place the parts in a washing bag. Do not place lining parts in the dryer: Excess heat may damage the foam and coverings. The faceshield may be cleaned with plastic polish or mild soap and water. The shell of your helmet should be cleaned using only a mild detergent and water.

Warning



For your safety, it is important that you completely read the owner's manual and all warning labels.

Although there is no visible damage on your helmet, general wear and tear over time may affect overall function of protective helmet and increase the risk of injury in accident. It is advisable to replace your helmet no later than every 5 years from purchase.

DO NOT



DO NOT ride without snugly fastening your chinstrap.

DO NOT clean your helmet with petroleum products, solvents, benzene, thinner or cleaning agents.

DO NOT paint over your helmet's finish without totally protecting and isolating the shock-absorbing liner and plastic parts.

Your warranty will otherwise be invalidated.

DO NOT drop your helmet from any height onto a hard surface. This could cause damage to your helmet's finished and/or decrease its ability to protect you.

DO NOT place your helmet on your motorcycle's rearview mirror: The sharp pressure from the mirror's edge will compress and damage the helmet's shock-absorbing liner.

DO NOT place your helmet on the motorcycle's seat or fuel tank. It can easily roll off and hit the ground causing damage to the

helmet. It is best to place your helmet on the ground so it cannot fall in any direction.

DO NOT ride with a scratched faceshield. This can impair your vision, especially at night.

DO NOT modify any part of your helmet, e.g., drilling the shell or cutting and pressing the shock absorbing liner. Installation of sound systems, speakers and microphones reduces your helmet's ability to protect you and is not recommended.

DO NOT use the helmet again if it has either been dropped or involved in an accident. Replace it even if the damage is not visible to the naked eye.

DO NOT wear a dark or tinted faceshield (including the retractable SpeedView™ Sunvisor) in dark or poor visibility riding conditions.

DO NOT place your headliners and cheek pads in the dryer after washing. Allow them to air dry.

DO NOT attempt to remove, change or replace your faceshield while riding your motorcycle or ATV.

DO NOT use paint which requires heat curing.

Warranty



Should you have a warranty claim, please call 888-672-6774 or email warranty@scorpionusa.com during business hours.

NOTE: The warranty is for defects in materials and workmanship only. There is no warranty for the helmets involved in accidents or that have been dropped or impacted.



MEMO