

EXO-1100

SCORPION
EXO[®]

TECHMANUAL



EXO-1100 Performance Features

1 SpeedView® SunVisor

Retractable interchangeable internal sun visor. Choose the up or down position with the flip of the switch. Features our exclusive EverClear® anti-fog coating on all surfaces.

2 EverClear® FaceShield

Features a hardened anti-scratch coating and inner surface is coated with our exclusive EverClear® anti-fog treatment.

3 AirFit® Liner Inflation System

Inflatable cheek pad bladders for a personalized fit.

4 KwikWick II® Liner Fabric

Improved moisture-wick properties and supple feel superior to our original KwikWick®. Hypo allergenic, removable and washable.

5 SpeedShift® Shield Quick-Change

A quick rotation of each SpeedShift® allows for easy shield changes in seconds.

6 Aero-Tuned Ventilation

Adjustable intake and exhaust ports for optimum airflow in warm conditions and warmth in cool conditions.

7 Face Shield Lock / Vent

Rotate lever to quickly crack the shield to 1/4" open or lock the shield in the closed position.

8 TCT® Composite Shell

Developed exclusively by Scorpion, the TCT® (Thermodynamic Composite Technology) shell is a proprietary blend of fiberglass, Kevlar® and organic poly-resin fibers to create an extremely light and durable shell matrix.

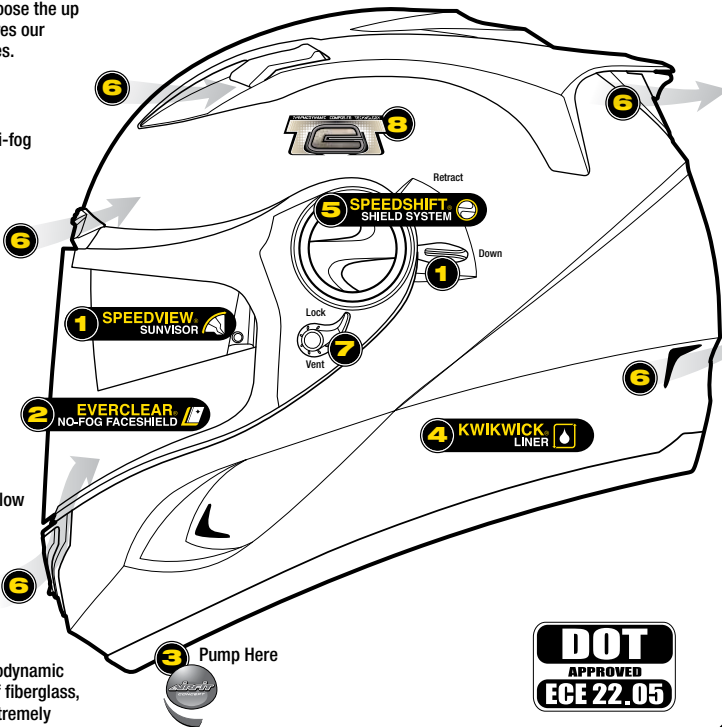

Introduction

Congratulations for acquiring a premium ScorpionExo™ helmet. This helmet embodies the latest, state-of-the-art design, engineering and technology available in the market today and is an excellent investment for your comfort and protection.

Please remember that no helmet can protect you against all possible or foreseeable impacts even when built with the latest and best materials and technology.

The following information will help you to enjoy and properly care for your helmet.

Function

A helmet's main function is to protect your head from impact in case of an accident. To accomplish this, a helmet surrounds your head with a matrix of materials designed to absorb and cushion impact energy in some accidents. A helmet is also designed to provide you with comfort while riding at speed and in various weather conditions. Yet, there is a trade-off: A helmet decreases hearing sensitivity, peripheral vision and physical movement to a certain extent while providing protection and comfort.

Fit

It is important for maximum safety that your ScorpionExo™ helmet fit snugly and comfortably on your head with the retention strap (chinstrap) properly and snugly fastened. With the chinstrap firmly fastened, grab the back of the helmet with both hands and try to roll the helmet forward. If you can roll the helmet over the eyes, it is too loose and you should try another size helmet.

FaceShields

The faceshield on your ScorpionExo™ helmet provides protection from weather, small flying objects and wind. Tinted shields are available to protect your eyes from excessive sunlight. The exclusive, patent-pending ScorpionExo™ “SpeedShift™” quick-change faceshield system allows you to easily change your shield in less than 10 seconds. See the instructions below in this manual.

NEVER WEAR A DARK OR TINTED FACESHIELD IN DARK OR POOR VISIBILITY RIDING CONDITIONS. This is not only unsafe, but also illegal in most states.

NEVER WEAR A FACESHIELD THAT HAS BECOME SCRATCHED, OR RIDE WITH A FACESHIELD THAT IS FOGGED BY CONDENSATION. SCORPIONEXO™ FACESHIELDS (CLEAR AND SMOKE ONLY) COME WITH A SCRATCH-RESISTANT COATING.

Ventilation Systems

Ventilation systems are designed and engineered to maximize your comfort in a wide range of temperatures. Familiarize yourself with the vents on your street helmet. Some vents have detents allowing partial opening and closing, thereby controlling intake and exhaust airflow. Your helmet ventilation systems should be kept clear of any obstructions including dirt, insects or other items which could interfere with proper flow of air. The ventilation systems play an important role, especially during physical exertion or hot-weather riding. Ventilation helps decrease the possibility of fogging and condensation.

SpeedView® Internal Sun Visor

Face Shield Lock/Vent Lever

NOTE: THE RETRACTABLE INTERNAL SUNVISOR CAN BE LOWERED AND RETRACTED, REGARDLESS OF WHETHER OR NOT THE FACESHIELD IS UP OR DOWN.

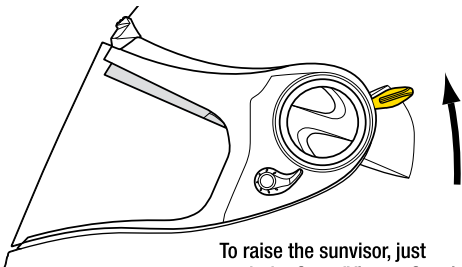

To raise the sunvisor, just push the SpeedView™ Sunvisor Retraction-lever up.

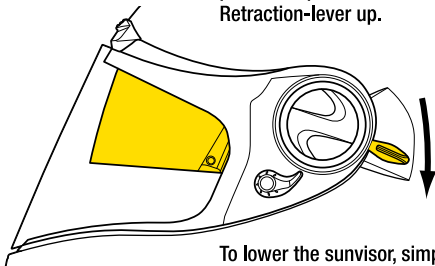

To lower the sunvisor, simply pull the SpeedView™ Sunvisor Retraction-lever down.

NOTE: FIRST, CLOSE SHIELD TO THE LOWEST POSITION TO LOCK/UNLOCK.

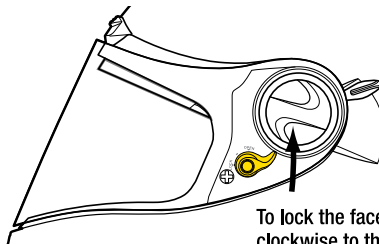

To lock the faceshield, turn Locking-lever counter-clockwise to the 2 o'clock position approximately. Test faceshield now to check if it is locked properly.

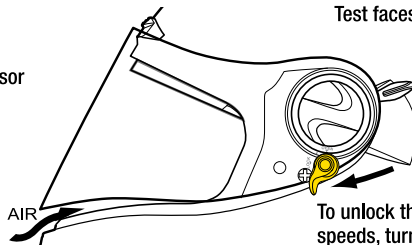

To unlock the faceshield, and provide air flow at low speeds, turn Locking-lever clockwise to the 7 o'clock position. Test faceshield now to check if it is unlocked properly.

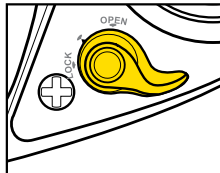

NOTE: When the lever is positioned at 4 o'clock, the shield is closed, but it is also unlocked.

SpeedView® Sun Visor Removal

NOTE: FIRST, OPEN OUTER SHIELD TO THE HIGHEST POSITION. THEN LOWER THE SUNVISOR TO EXPOSE THE SIDE BRACKET, WHICH HOLDS THE SUNVISOR IN PLACE.

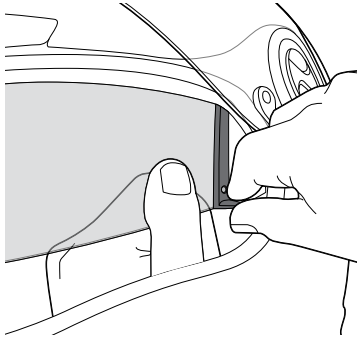

Hold the sunvisor with your left hand. Gently, pry apart the side bracket by pulling the arm towards you. The small post on the shield surface will disjoin from the groove in the side bracket.

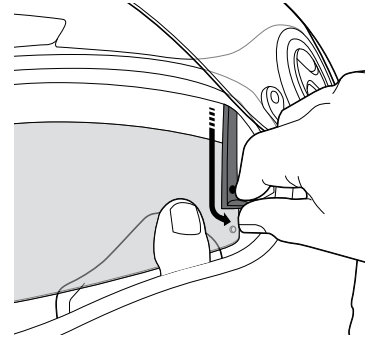
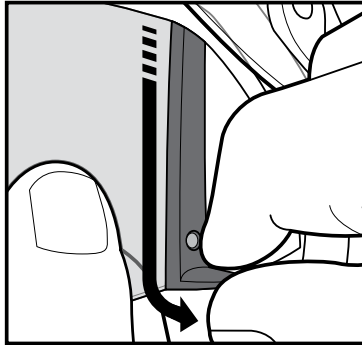

Release the shield from the clasp, pulling downwards slightly. With one side now disjoined, pry apart the other side to completely detach your SpeedView™ sunvisor.

Reverse process for installation.

Cheek Pads Removal

Occasionally the cheek pads may require removal for washing, replacement or to change sizes.

First step is to remove the Aero Skirt. (refer to page 7).

Then slide your thumb behind the cheek pad at the area closest to the AirFit inflation pump and gently tug the cheek pad away from the helmet interior wall. There are three plastic snaps that require unsnapping (shown in yellow).

At the same time slide the plastic trim out of the helmet channel.

Repeat this process for both cheek pads.

Once both cheek pads are removed you can also remove the crown liner component. (refer to page 6)

Reverse this process for installation.

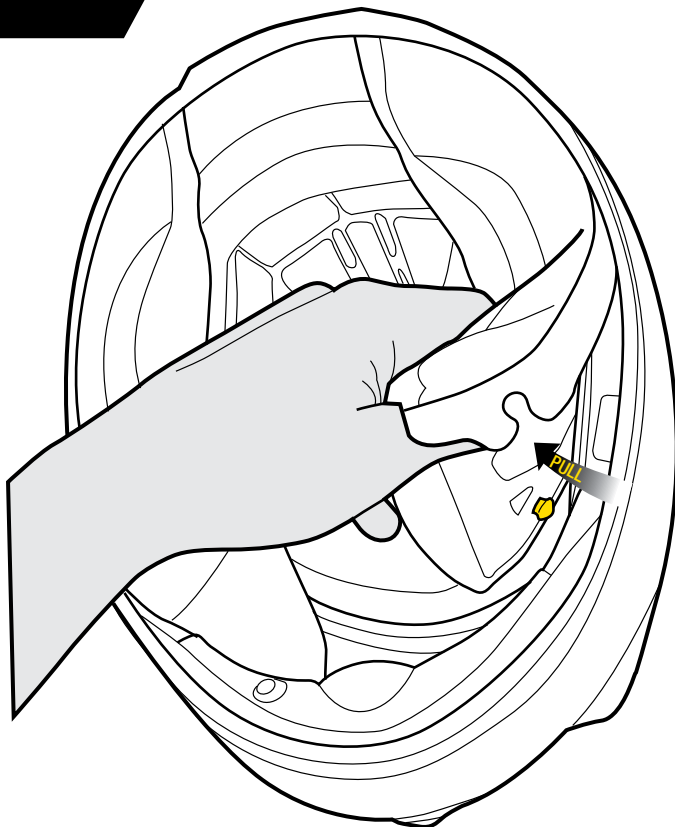

Crown Liner Removal

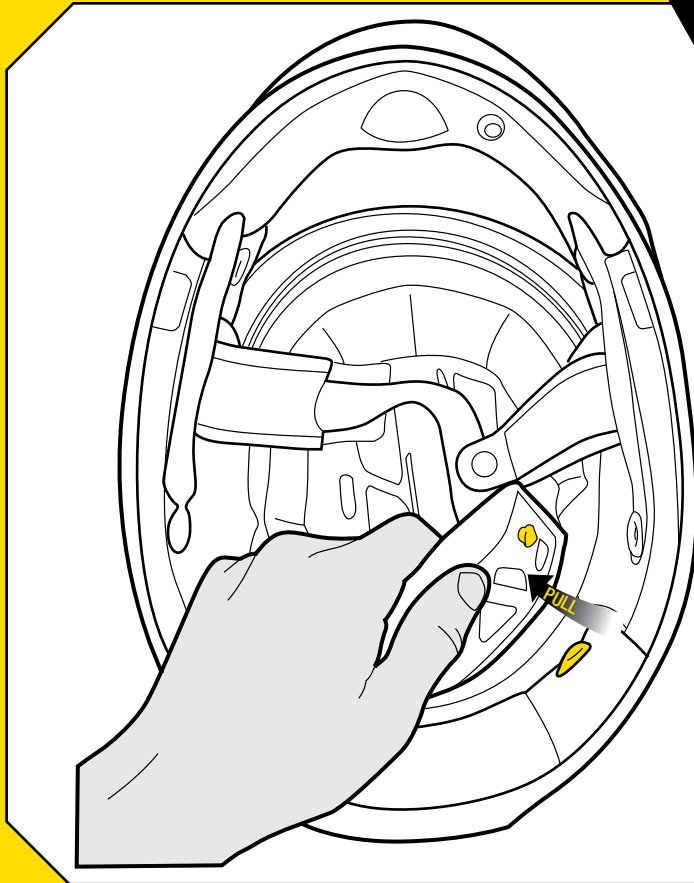

Occasionally the crown liner may require removal for washing, replacement or to change sizes.

First step is to remove the cheek pads. (refer to page 5).

At the back of the helmet pull the crown liner away from the shell unfastening the two snaps (shown in yellow). Pull the crown liner out of the helmet while gently detaching it from the forehead channel.

Reverse this process for installation.

Aero Skirt Removal

The pliable Aero Skirt was designed to reduce wind from entering behind the face shield area, specifically to keep your face warmer in cold weather.

You do however have the option to remove the Aero Skirt for cleaning or for warmer riding conditions.

TO REMOVE

Simply tug on the Aero Skirt and it slides out of the rubber trim channel.

Reverse this process to re-install.

NOTE:

The Aero Skirt does not require removal to access the AirFit inflate and deflate functions.

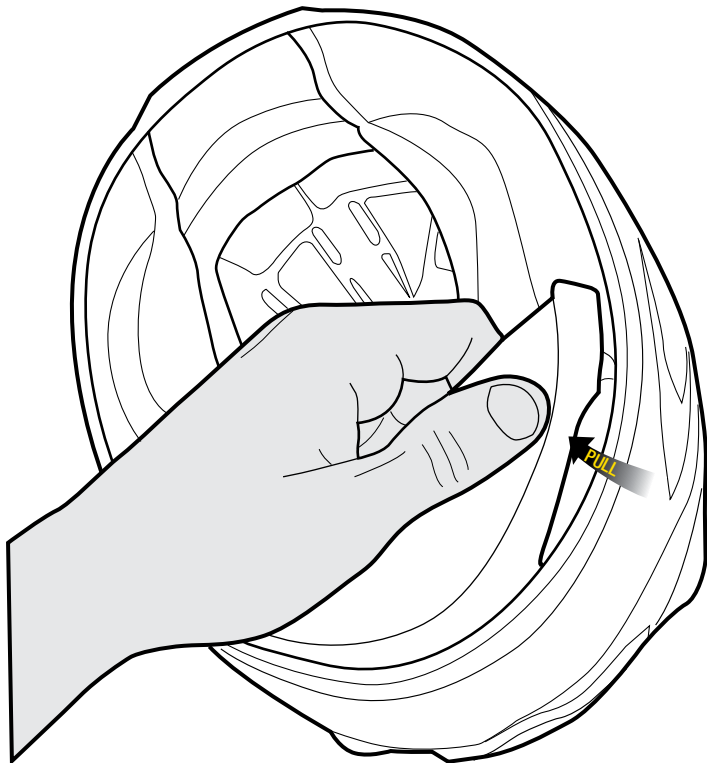



Inflatable Liner

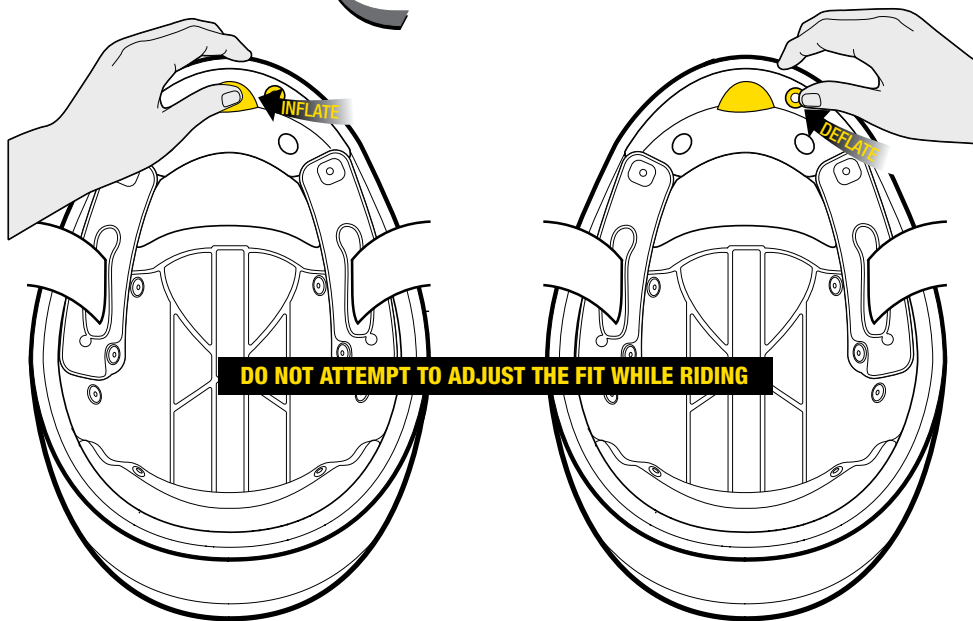

INFLATION

While wearing the helmet press the large ball until you reach the desired fitment.

DEFLATION

Press the small button to release the air. **DO NOT** remove the helmet without first deflating the liner.

DO NOT modify, puncture, or damage the air bladders in any way. If the air bladders, or any other part of the inflation/deflation system becomes damaged or faulty, please contact Kido Sports USA at 888-212-0688

FaceShield Replacement

NOTE: THE FACESHIELD CAN ONLY BE REMOVED OR INSTALLED WHEN IN THE FULLY OPENED POSITION!!!

To remove your faceshield, place the helmet in front of you with the eye port facing away. Ratchet the faceshield up to the fully open position. Using both hands, rotate both circular SpeedShifters™ clockwise; because they are on opposite sides of the helmet, it will feel like you are twisting them in opposite directions. The shield will release immediately from the SpeedShifter locking mechanism. Then, with both of your thumbs pushing squarely on the center of the SpeedShifters, gently pull or “peel” the faceshield away from the helmet.

**SPEEDSHIFT®
SHIELD SYSTEM**

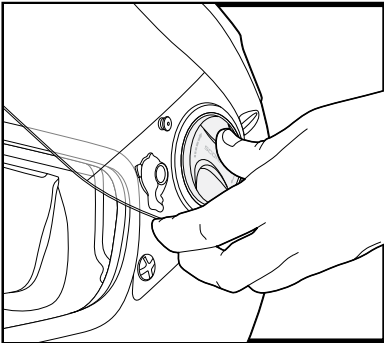

IMPORTANT NOTE:
Be sure to hold down the SpeedShifters securely with your thumbs while removing the faceshield!

Securing and Wearing your Helmet

Do not simply pull your helmet down onto your head like a hat. Your ScorpionExo™ helmet should be worn as follows: Using both hands, grab the helmet's bottom rim while holding the chin straps with your thumbs, then “roll” the

helmet onto your head starting at the forehead. Continue rolling the helmet on toward the back of the head until it comes to rest with your head fully in contact with the inner linings and cheek pads. Finally, **FIRMLY AND SECURELY FASTEN YOUR CHINSTRAP.** Check your chinstrap for tightness occasionally as vibration or wind may loosen it.

Latching your chin strap

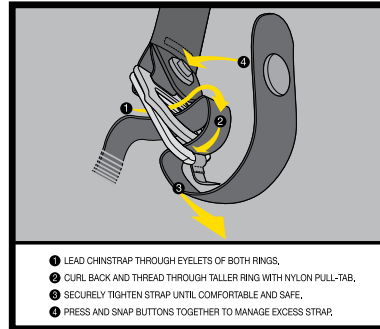

Cleaning Your Helmet System

None of the components of your ScorpionExo™ helmet can be damaged by water. All headliners and sweat-wicking cheek pads are machine washable. Wash them with a mild detergent in warm water and allow to air dry. Hand washing is recommended, but machine washing is also permitted. Use the “delicate” cycle to prevent the agitator from damaging the

sweat-wicking material covering the liner parts. Do not place lining parts in the dryer: Excess heat may damage the foam and coverings. The faceshield may be cleaned with plastic polish or mild soap and water. The shell of your helmet should be cleaned using only a mild detergent and water. NEVER USE PETROLEUM BASED CHEMICALS, SOLVENTS, GASOLINE, CLEANING AGENTS OR ADHESIVES to clean the shell, liners or faceshield of your helmet. Your helmet shell, liner and faceshield may be seriously damaged by the use of such products.

Warning

For your safety, it is important that you completely read the owner's manual and all warning labels.

Don't's

DON'T ride without snugly fastening your chinstrap.

DON'T clean your helmet with petroleum products, solvents, benzene, thinner or cleaning agents.

DON'T paint over your helmet's finish without totally protecting and isolating the shock-absorbing liner and plastic parts.

Your warranty will otherwise be invalidated.

DON'T drop your helmet from any height onto a hard surface.

This could cause damage to your helmet's finish and/or decrease its ability to protect you.

DON'T place your helmet on your motorcycle's rearview mirror:

The sharp pressure from the mirror's edge will compress and damage the helmet's shock-absorbing liner.

DON'T place your helmet on the motorcycle's seat or fuel tank. It can easily roll off and hit the ground causing damage to the helmet. It is best to place your helmet on the ground so it cannot fall in any direction.

DON'T ride with a scratched faceshield. This can impair your vision, especially at night.

DON'T modify any part of your helmet, e.g., drilling the shell or cutting and pressing the shock absorbing liner. Installation of sound systems, speakers and microphones reduces your helmet's ability to protect you and is not recommended.

DON'T use the helmet again if it has either been dropped or involved in an accident. Replace it even if the damage is not visible to the naked eye.

DON'T wear a dark or tinted faceshield (including the retractable SpeedView™ sunvisor) in dark or poor visibility riding conditions.

DON'T place your headliners and cheek pads in the dryer after washing. Allow them to air dry.

DON'T attempt to remove, change or replace your faceshield while riding your motorcycle or ATV.

DON'T use paint which requires heat curing.

Warranty

Should you have a warranty claim, please call 888.212.0688 during business hours (Pacific Standard Time) and ask for the warranty department. You may also take your helmet to your local dealer for evaluation. For minor repairs, the dealer may be able to help you with an assortment of spare parts or accessories.